



## SUPPLEMENT TO CERTIFICATE No. CAF196 & CF5228 SUPPLEMENT No. 370952 – Issue 2

This supplement is issued as an amendment to the Certificate of which it constitutes an integral part. It should be read in conjunction with the Certificate and any other supplements in force at the time. Supplements are incorporated into Certificates at the time of their re-issue.

### DOORPAC LIMITED

Unit 6 Ranskill Court, Sheffield, S9 5FZ  
Tel: 0114 256 1615

#### CERTIFIED PRODUCTS

Doorpac Limited – CAF196 & CF5228

#### SCOPE OF SUPPLEMENT

Timber System 7 frames for use with Falcon CF807 and Doorpac CF5228 doors

##### Option 1

- Min. 44 mm thick frame required
- Frame specification to be in accordance with CAF196 (CF807) or CF5228
- Option for the 45 mm frame section to be made from a standard 30 mm frame lining bonded to an additional 15 mm section. A 20 mm by 2 mm Palusol or Graphite intumescent is to be fitted to the rear of the 30 mm lining section.
- Min. partition thickness to be maintained in accordance with CF807 or CF5228

1. Ask aa-R15 Aluminium 'Z' section – supplied loose for fitting on site.
2. 10 mm deep intumescent mastic applied during installation in accordance with BS 8214.
3. Ask aa-PT15 Aluminium 'W' section – factory fitted to back of door lining.

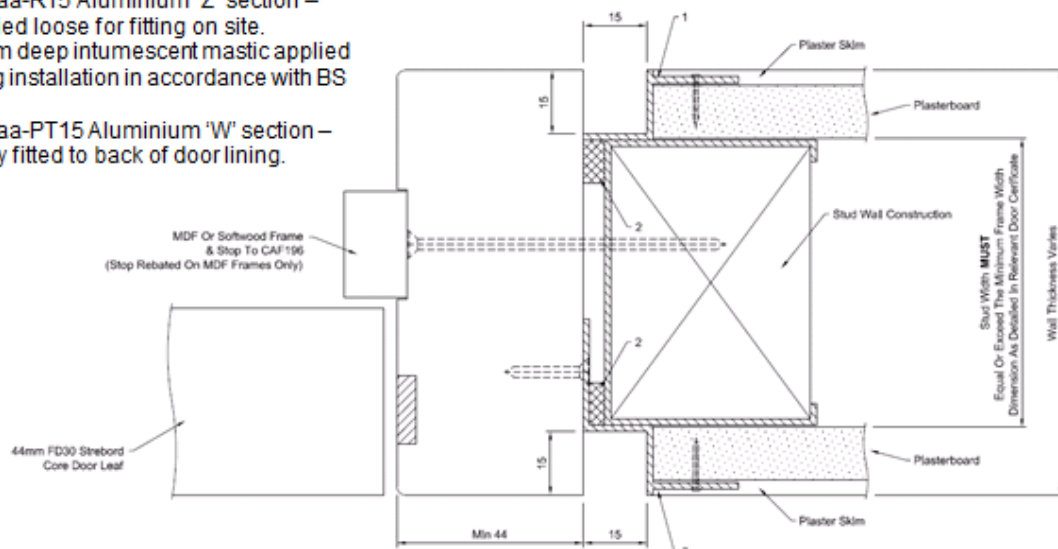

## SUPPLEMENT TO CERTIFICATE No. CAF196 & CF5228 SUPPLEMENT No. 370952 – Issue 2

This supplement is issued as an amendment to the Certificate of which it constitutes an integral part. It should be read in conjunction with the Certificate and any other supplements in force at the time. Supplements are incorporated into Certificates at the time of their re-issue.

### Option 2

- Min. 30 mm thick frame required
- Frame and stop to be hardwood with a minimum density of 640kg/m<sup>3</sup> excluding Ash / Beech / Iroko.
- 10 mm by 4 mm thick intumescents required to the rear of the frame adjacent to the shadow gap detail as shown
- Min. partition thickness to be maintained in accordance with CF807 or CF5228

1. Ask aa-R15 Aluminium 'Z' section – supplied loose for fitting on site.
2. 4 mm by 10 mm intumescent factory fitted into machined rebate.
3. 10 mm deep intumescent mastic applied during installation in accordance with BS 8214.
4. Ask aa-PT15 Aluminium 'W' section – factory fitted to back of door lining.

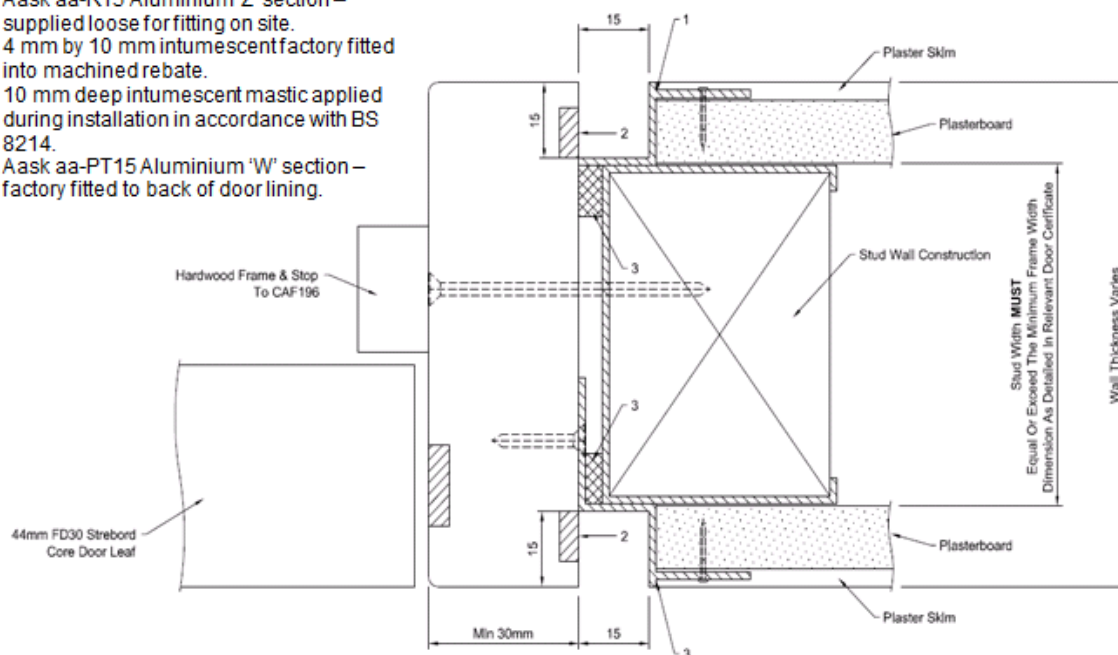

All other scope relating to doorset design and configuration should comply with CAF196 (CF807) or CF5228 accordingly.

Issued for and on behalf of CERTIFIRE

P Duggan – Manager

Issued: 15<sup>th</sup> February 2022

Valid to: 14<sup>th</sup> February 2027

